

Chamlide TC-W

Incubator System for Various Types of Chambers and Well Plates



- Easy and fast replacement of the plate by magnetic force
- Any types of commercial well plates are usable.
- All adaptors for a standard TC are usable.
- 8 types of adaptors are usable.
- Able to use with most microscope stages
- Able to use with various Chamlide magnetic chambers, commercial culture dishes, and commercial well plates
- CU-501 regulates the temperature of the incubator main body, incubator cover, humidifier, and lens warmer.
- CU-501 adjusts the flow rate of the mixed CO₂ gas by flow meter.
- Glass incubator cover is coated by heating element.
- Optimum mixed gas provided to all incubator systems with FC-5N or FC-9 (e.g. Chamlide TC, WP, and IC instead of pre-mixed 5% CO₂/ 95% air gas)
- In/out ports without opening the incubator cover using CM-B-PA, CM-B-PB (e.g. perfusion, injection of liquids, drugs: see page 42)
- Able to control the temperature, gas concentration, and to program the temperature and the gas concentration gradients
- Able to record the temperature and gas concentration over time using CCP ver.7 software or MetaMorph software

Specification

Temperature range	Ambient +3°C ~ +45°C
Recommended 5% CO ₂ / 95% Air flow rate	100 ml/ min
Incubator physical dimension (mm)	Cover 164.9 (W) x 134 (D) x 11 (H) Main body 160.0 (W) x 130 (D) x 14 (H) (insert part) (160 x 110, universal K insert size)
Heating method	Cover invisible coating heater Main body thin layer heater Humidifier cartridge heater Lens warmer thin layer heater
Sensor	PT 10 ohm
Incubator material	Black anodized aluminum alloy

Model No.

TC-W-10

Product

Chamlide TC-W-10

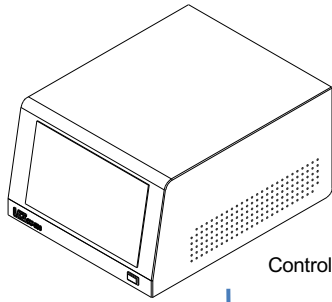

Controller (CU-501)

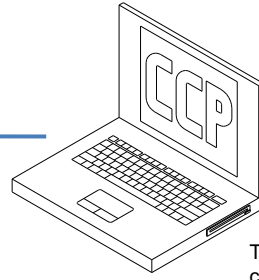

Temperature & gas composition controlling software

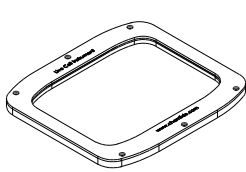

Incubator cover

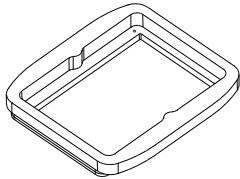

Incubator main body



Humidifier

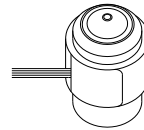

Lens warmer

